

REQUEST FOR ROLLER SHUTTERS FOR SPECIAL VEHICLES

CUSTOMER					
DATE					
DELIVERY DATE					
NOTE					
OFFER	N°		ORDER		N°

SLIDING SYSTEM ECO SIMPLY

ECO SIMPLY



ECO SIMPLY PLUS

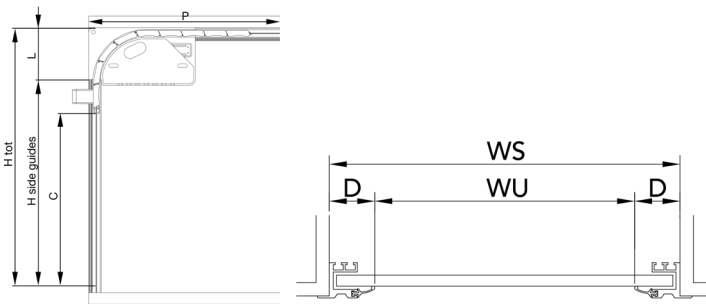

SHUTTER DIMENSIONS

QUANTITY				
Total Width (WS)				
Total Height (Htot)				
Height guide (Hg)				
Sliding Room (L)				
Depth (P)				

SHUTTER DIMENSIONS

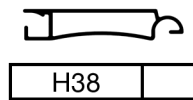
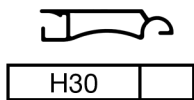

FINISHING

Standard
anodized

RAL
7035

RAL
.....

SIDE PROFILE FOR H30 & H38

SIMPLY

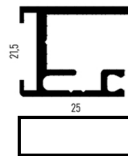

CLOSING SYSTEM



WITH KEY

WITHOUT KEY



WITH KEY

WITHOUT KEY



WITH KEY

WITHOUT KEY

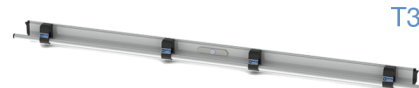

WITH KEY

WITHOUT KEY

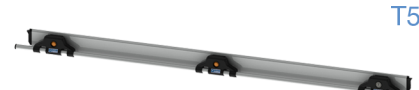

WITH KEY

WITHOUT KEY

¹ Double or central key available (options)

REQUEST FOR ROLLER SHUTTERS FOR SPECIAL VEHICLES

OPTIONS

GUTTER PROFILE

SMALL



ANODIZED

RAL _____

BIG

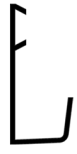

ANODIZED

RAL _____

LOWER PROFILE

SMALL



ANODIZED

RAL _____

BIG



ANODIZED

RAL _____

PULLING BELT



1 M

ELA 1

2 M

ELA 2

* Only for ECO Plus Simply

UPPER SHUTTER PROFILE WITH GASKET



ANODIZED

RAL _____

LED



L 500 mm

L 1000 mm

* LEDs are compatible with 12 V and 24 V systems.

** LEDs are mounted under the extension. It must be more than 600 mm.

INTERNAL OPENING

YES

NO

* Available only for T2

NOTE