

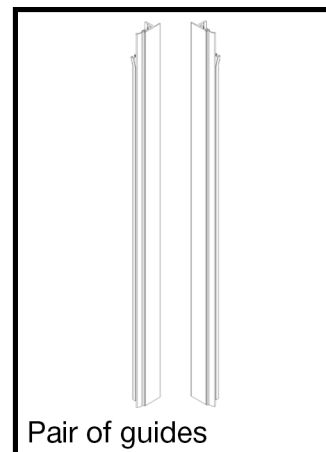

Installation instructions TOP-E

**STANDARD
MOTOR**

Common parts

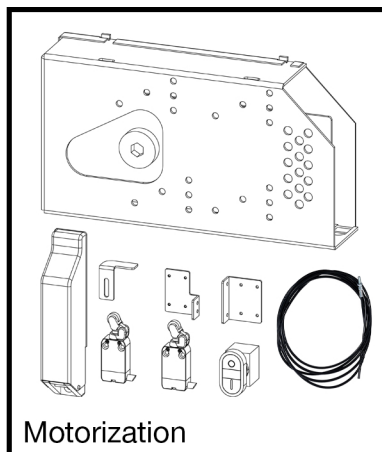
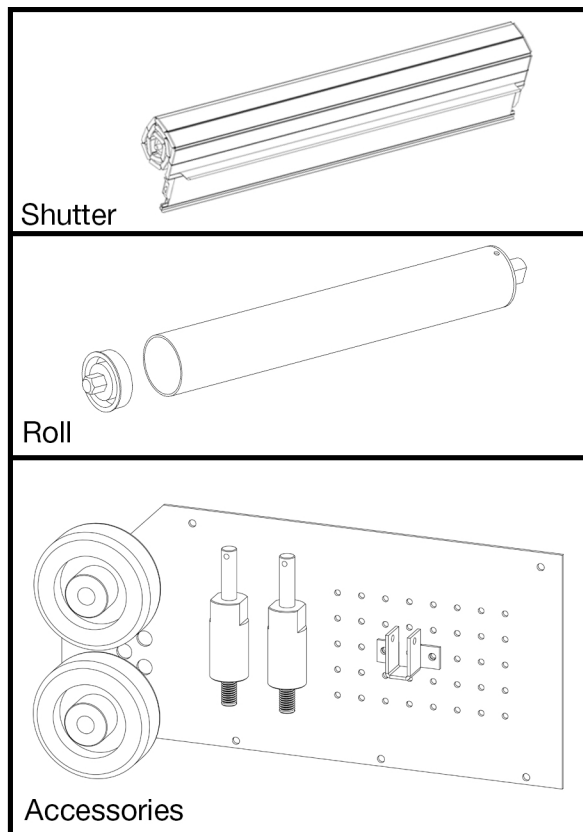

Num. Art.	Codice Code	Descrizione	Description	Q.tà Q.ty
1	70900	Terminale E-T8	Closing system E-T8	1
2	70061	Riscontro finecorsa	Reply limit switch L/R	2
3	70001.38/A	Profilo serranda H38	Shutter profile H38	N
4	70004	Gomma intermedia	Middle rubber for shutter profile	N
5	70002.SX.38	Pattino sinistro H38	Left sliding plate H38	N
6	70002.DX.38	Pattino destro H38	Right sliding plate H38	N
7	70003.MP4/A 70003.MP5/A	Guida MP4 Guida MP5	Side profile MP4 Side profile MP5	2
8	70005	Gomma guide di tenuta anteriore	Seal rubber	2
9	70062	Supporto inferiore finecorsa	Lower limit switch support	1
10	70073	Finecorsa	Limit switch	2
11	70064	Maniglia di sgancio con coperchio	Release handle with cover	1
12	70070	Pulsantiera di comando	Command button	1
13	70060	Supporto superiore finecorsa	Higher limit switch support	1
14	70071	Motore destro	Right motor	1
15	70020	Rullo ø45	Roll ø45	1
16	70017	Sede - supporto per rullo (DX)	Roll space	1
17	70020.4E	Piolo rullo a testa esagonale	Hexagonal head pin for roll	1
18	70015	Piastra di fissaggio	Fixing plate	1
19	70022_128	Gruppo ruota ø128	Wheel group ø128	2
20	70012	Angolare superiore 50x20 (copertina)	Little cover 50x20	1
21	70011.S 70011.B	Profilo gocciolatoio PICCOLO Profilo gocciolatoio GRANDE con gomma	SMALL gutter profile BIG gutter profile with rubber	1
22	70014.S 70014.B	Profilo battuta PICCOLO Profilo battuta GRANDE	SMALL lower profile BIG lower profile	1

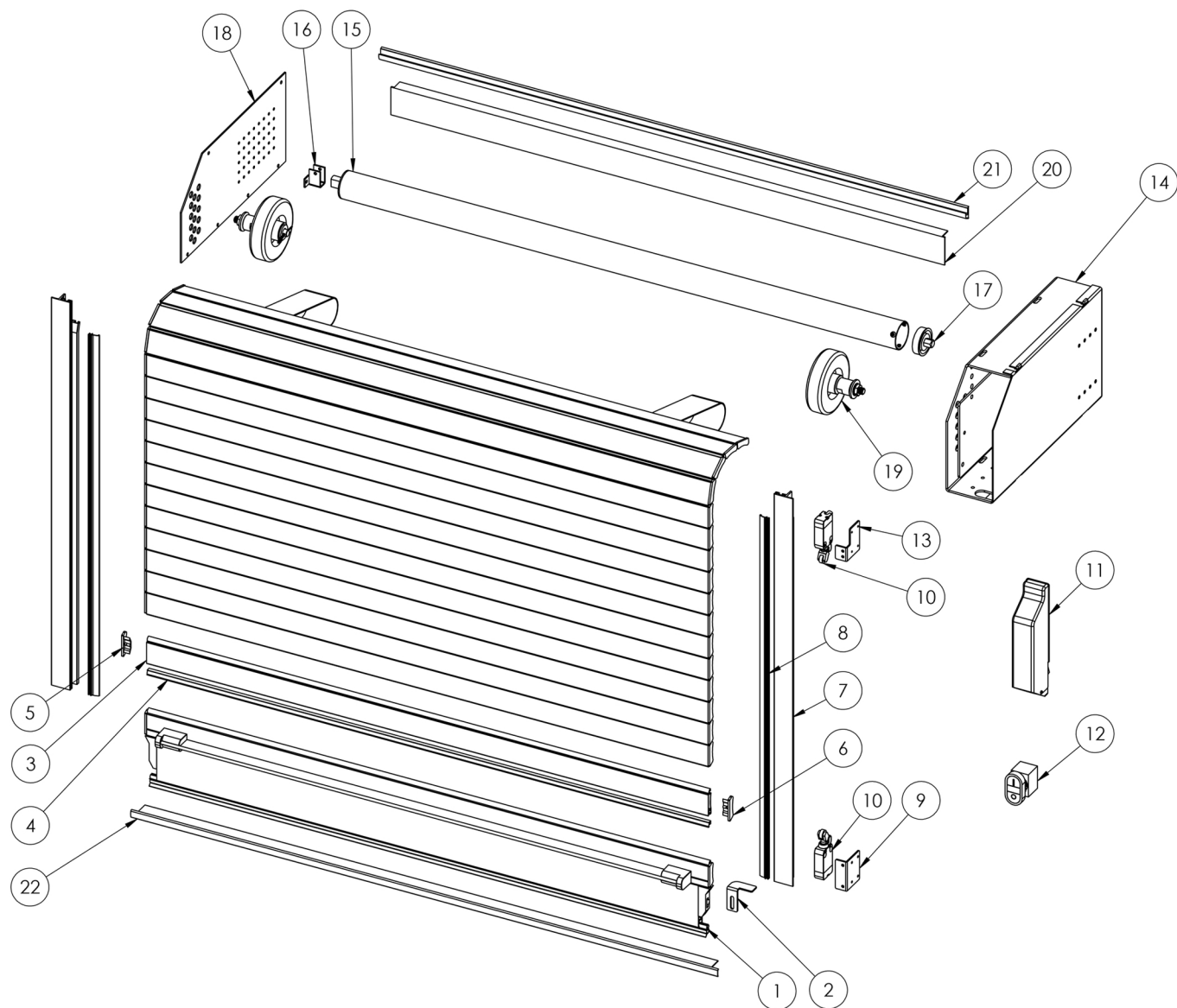

1. Drill and fix the lower profile (optional).

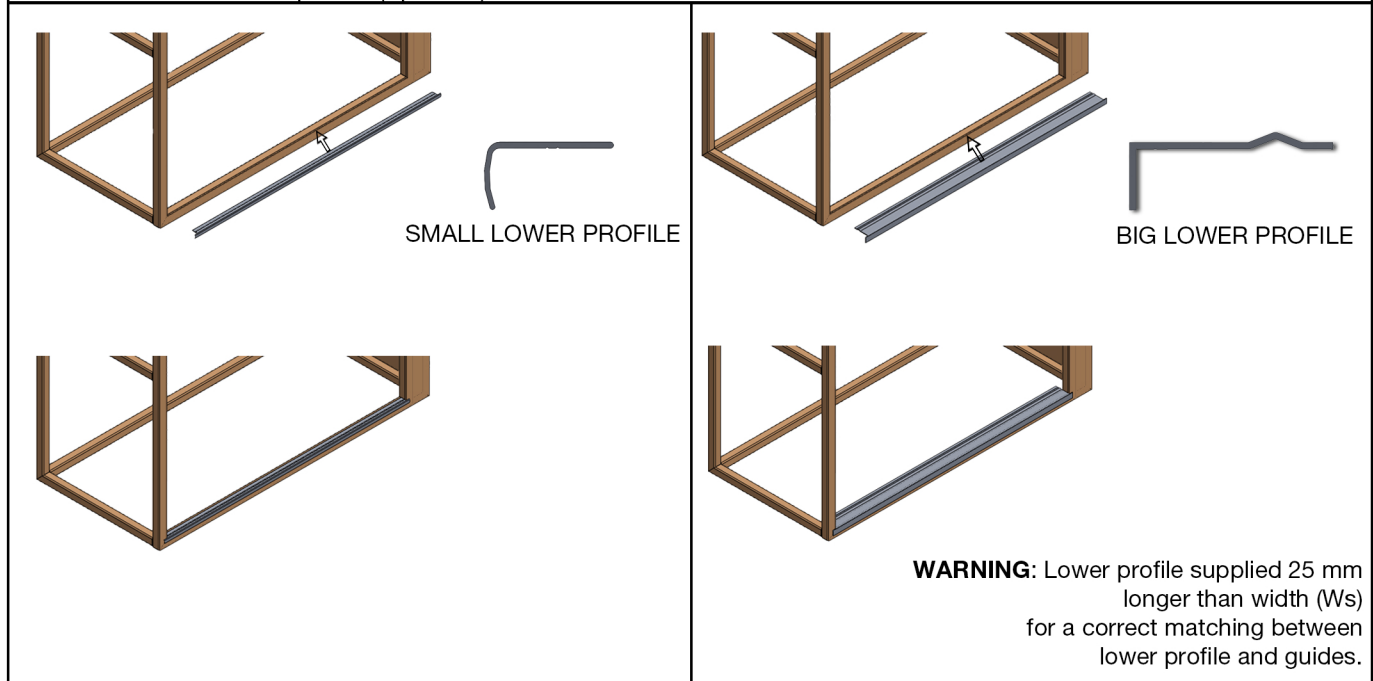

2. Drill and place the guides, fixing them temporarily.

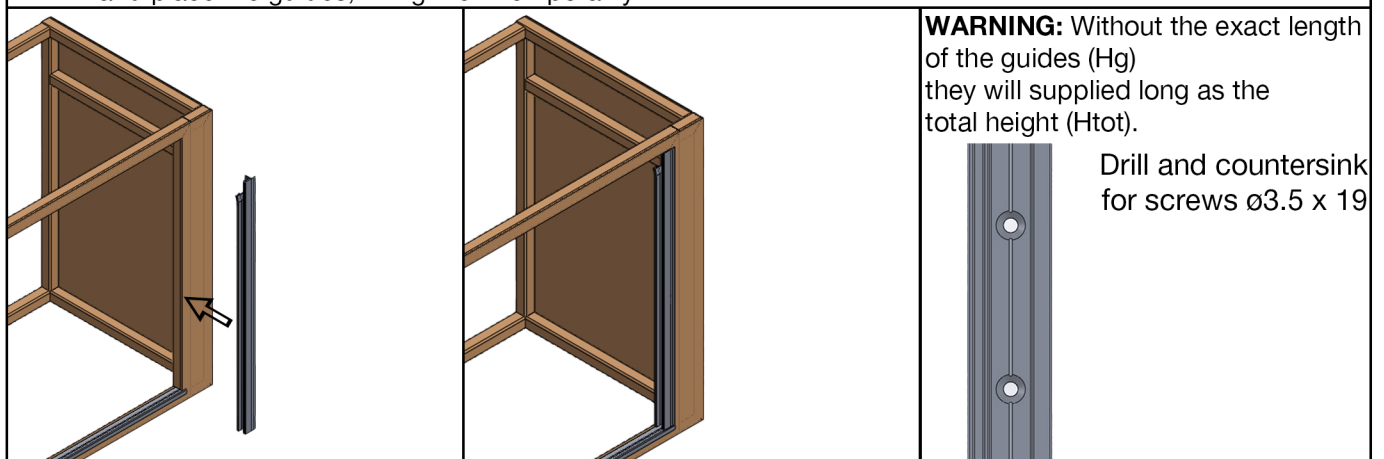

3. Drill and fix the little cover, L profile 50 x 20 (optional)

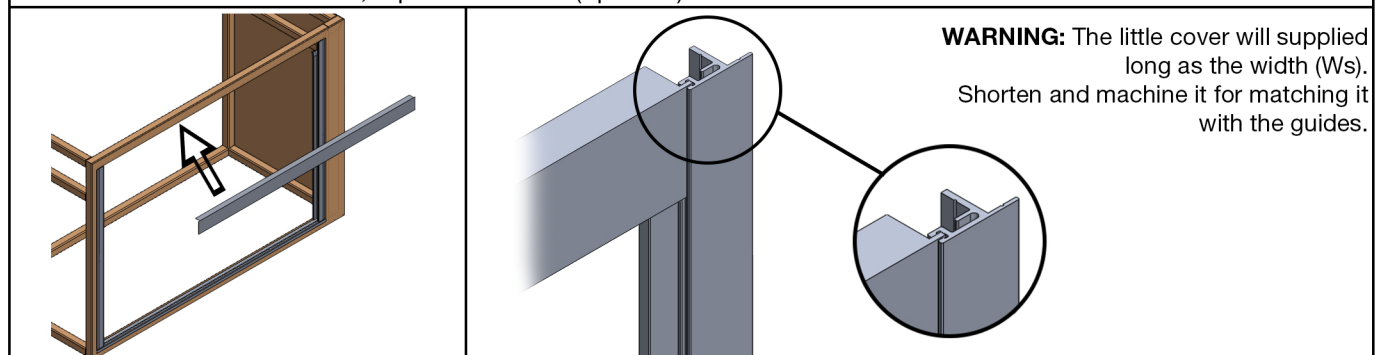

4. Fix the plate correctly as shown below.

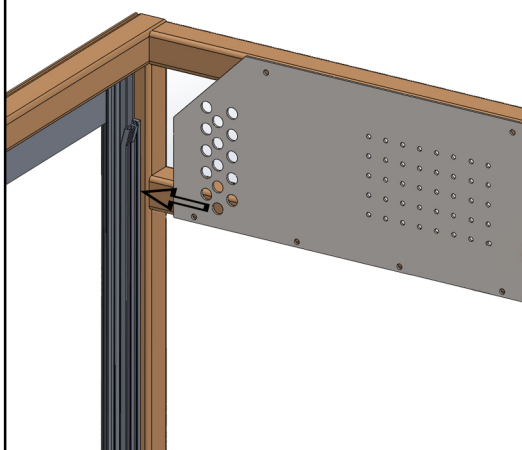

WARNING: The plate must be fixed against the guide.

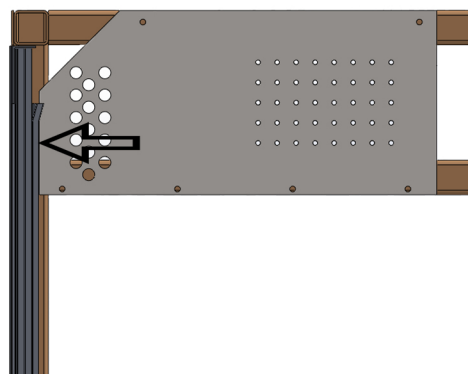

5. Place the motor in correspondence with the plate on the opposite side.
(The motor cover works as a plate on the side opposite at the standard plate)

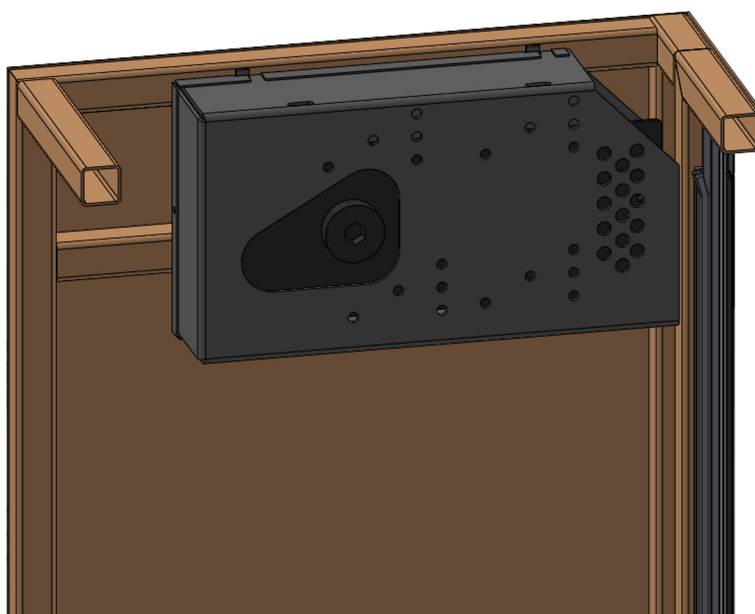

6. Define the correct position of the wheel, taking into account the informations below.



- Ⓐ Wheel ø 80: placed in the first row.
The wheel can be moved, up or down, along the first row of holes.

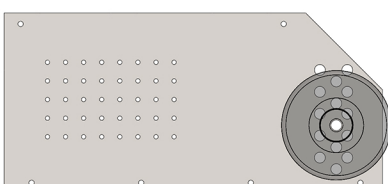

- Ⓑ Wheel ø 100: placed in the second row.
The wheel can be moved, up or down, along the second row of holes.

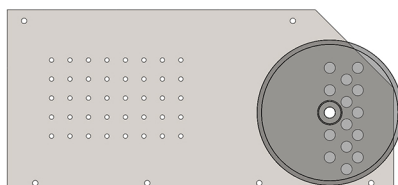

- Ⓒ Wheel ø 100: placed in the third row.
The wheel can be moved, up or down, along the third row of holes.

WARNING: Adjust the wheel in order to close the space (light) between the shutter and your frame or L of 50x20 little cover (if supplied). This operation should allow a proper function of the shutter, considering the diameter of the wrapped shutter.

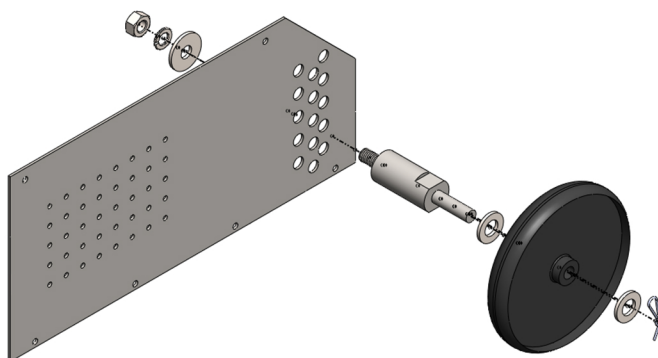

7. Mark on the guide the intersection point between the guide and the little cover - L profile 50x20.
The mark will help you to know the correct measure of the seal rubber.
After that **REMOVE** the guides.

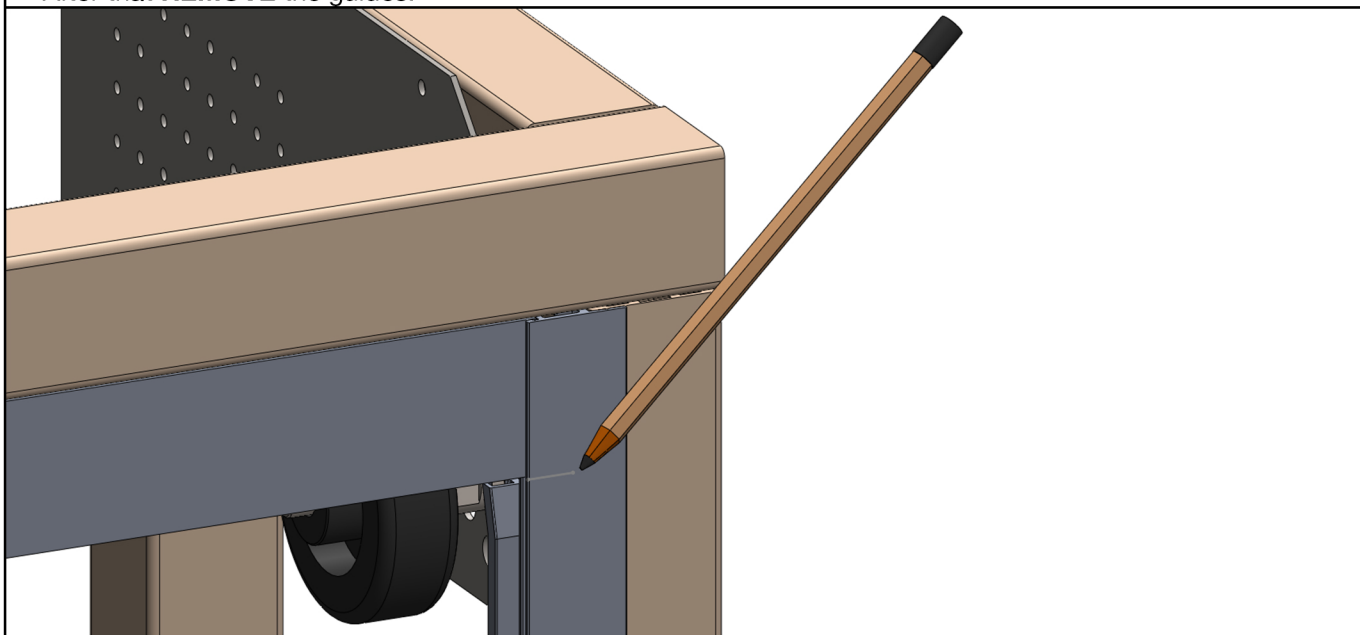

8. Cut the seal rubber diagonally and insert it in the guides, after that cut to measure considering the mark made before (point 7).

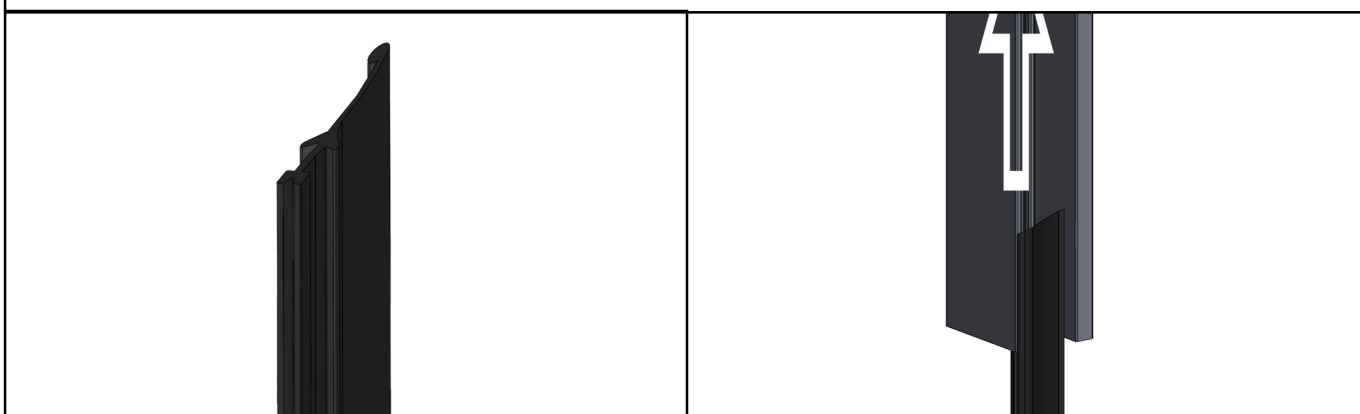

9. Fix the supports for the limit switches, as shown in the figure, on the engine side guide

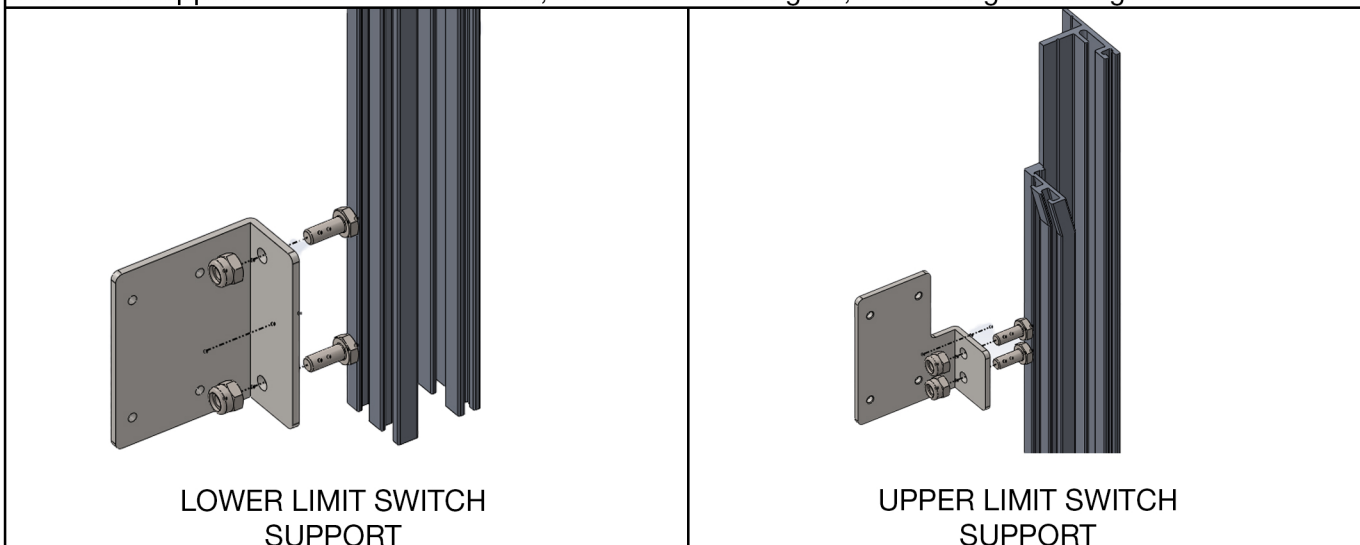

10. If you have LED, as optional, insert into the guide the supplied bolts for its fixing, as the image below. Insert the bolts in the guide opposite to the motor side.

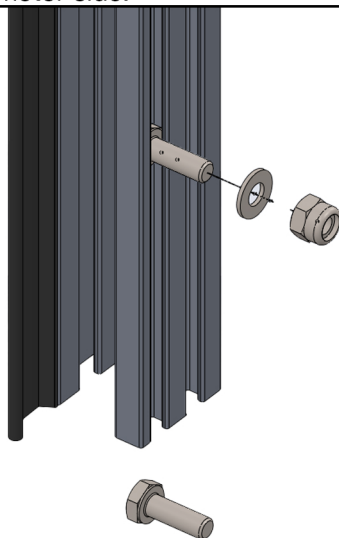

11. Screw the roll holder into the correct position, considering the diameter of the wrapped shutter. The roll holder should not interfere with the roof or other parts of the bodyworks or the shutter.

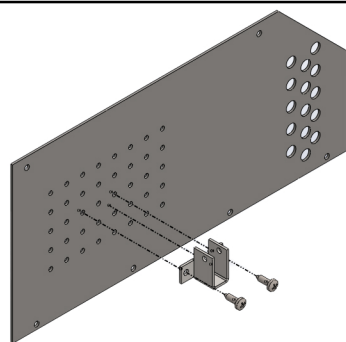

Roll holder

WARNING: Mount the holder on the plate opposite to the engine.

- 11a. Wrapped diameter obtainable by measuring the wrapped shutter as received.

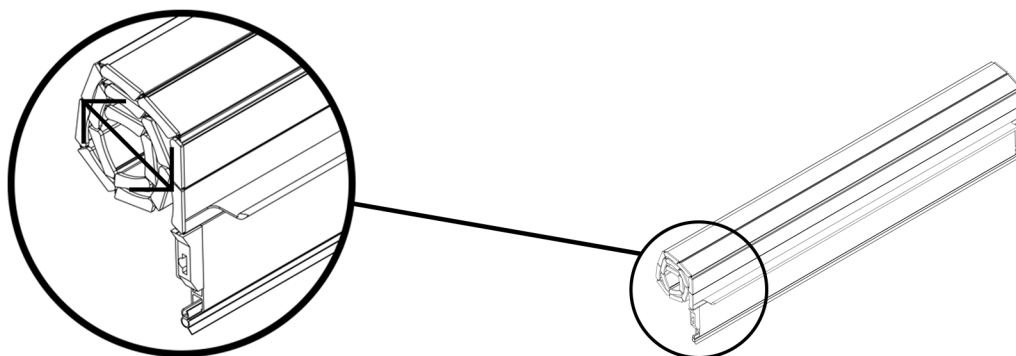

12. Shorten the aluminum tube $\varnothing 45$ e fix the hexagonal head plug, by the supplied screws; to get a correct match of the roll in the hexagonal hole on the motor and in the support of the square pin of the roller.v

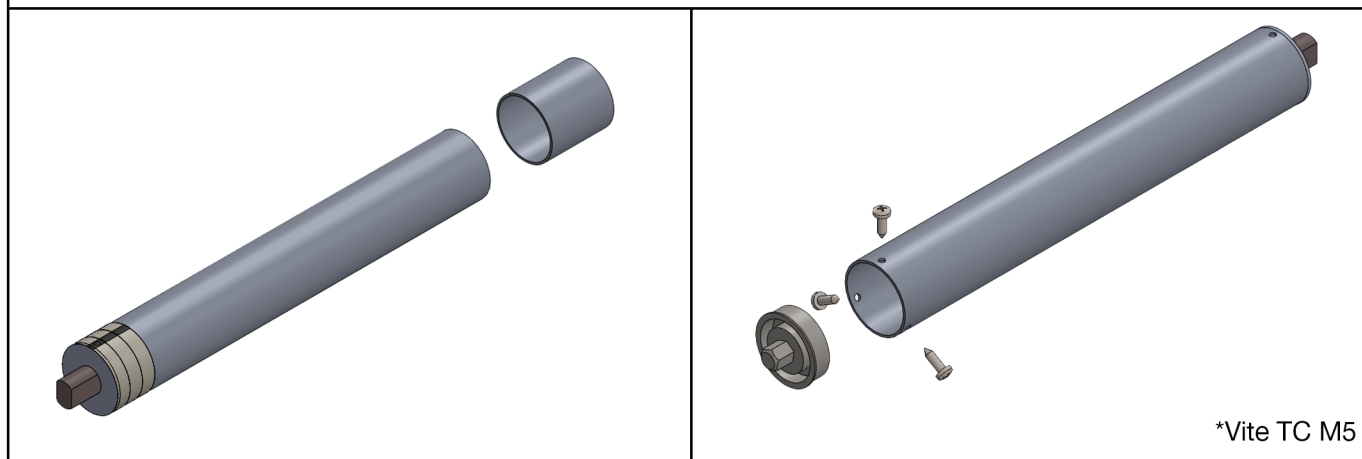

13. Place the roll in its holders, **KEEP THE BLACK BAND DOWNWARDS.**

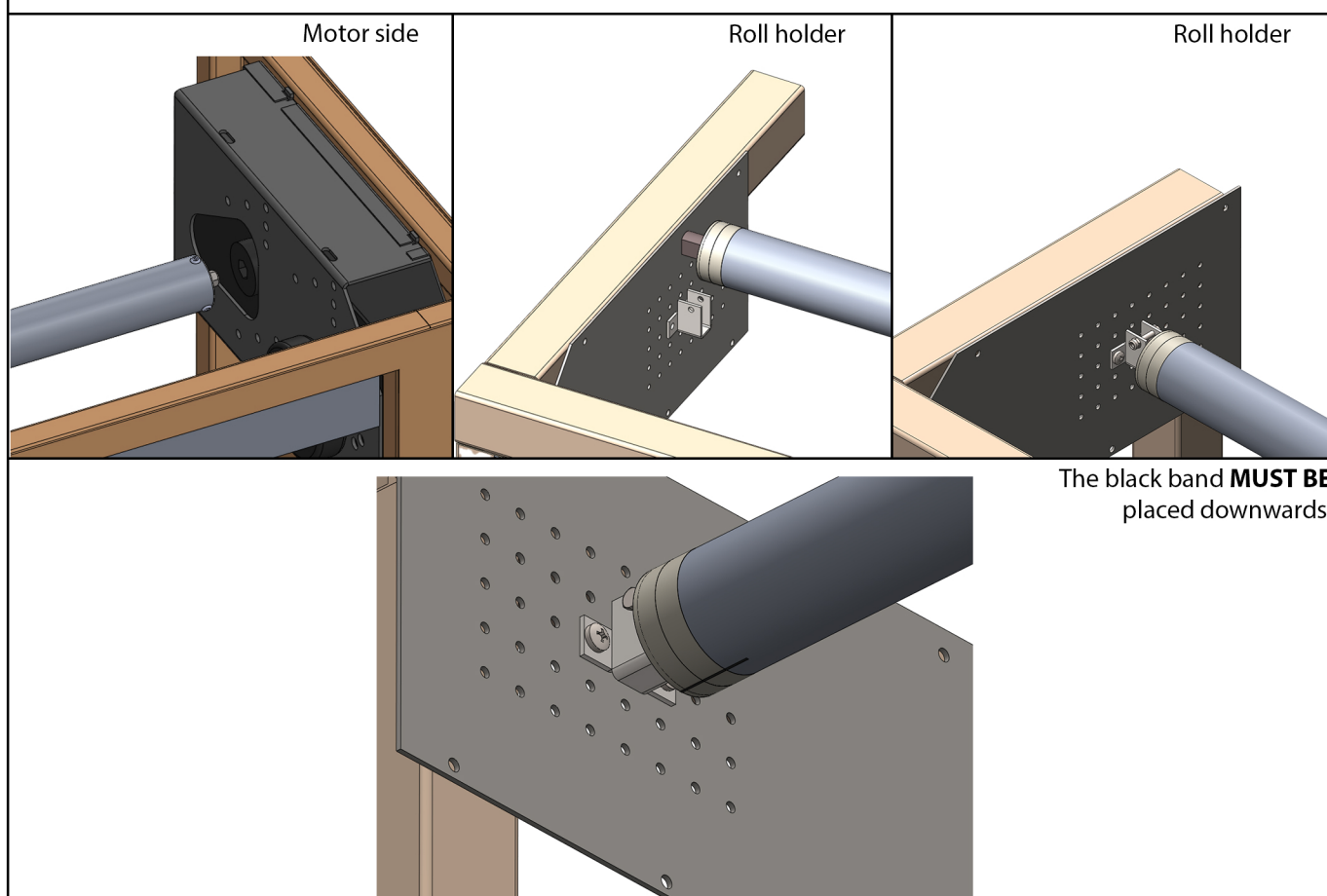

14. Place the shutter above the roll, bringing it to its maximum opening (A).
Place the guides and make sure that the shutter remains inside them (B).
Complete any drilling and countersink of the guides and fix them - screws $\varnothing 3.5 \times 19$ (C).

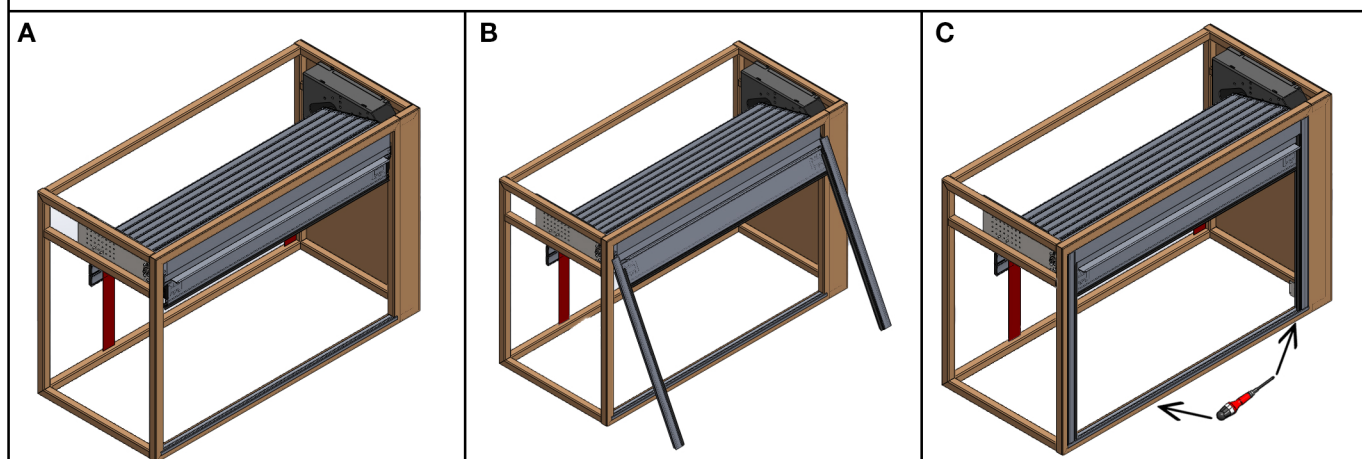

15. Mount the release handle (A). Screw one end of the can to the handle. Screw the other end, cut to measure in one of the three holes at the bottom of the motor (B). Insert the cable into the seat of the handle and in the can, until the motor. Fix the cable with the nut end cut off the excess (C).
Lift the release handle and release the motor..

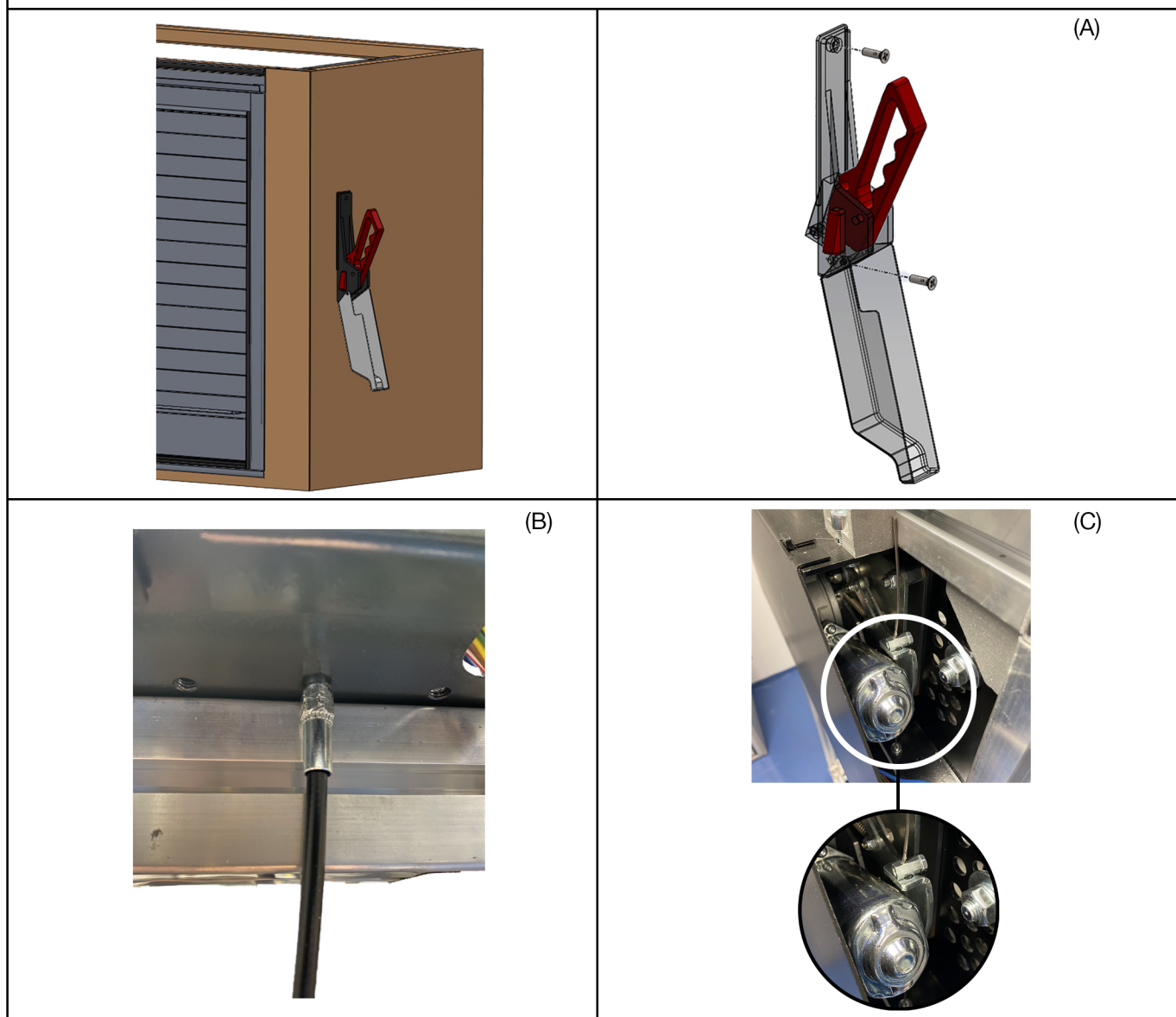

16. Fix the straps to the roll through the supplied rivets - rivets $\varnothing 4,8 \times 12$ - T16 (A).
Remove the protection paper from the roll (B)
ATTENTION: The safety pin will come off and the roll will be in charging position.
Hold the roll by turning it a half turn towards the inside of the compartment (C).
WARNING: The shutter will completely roll up.

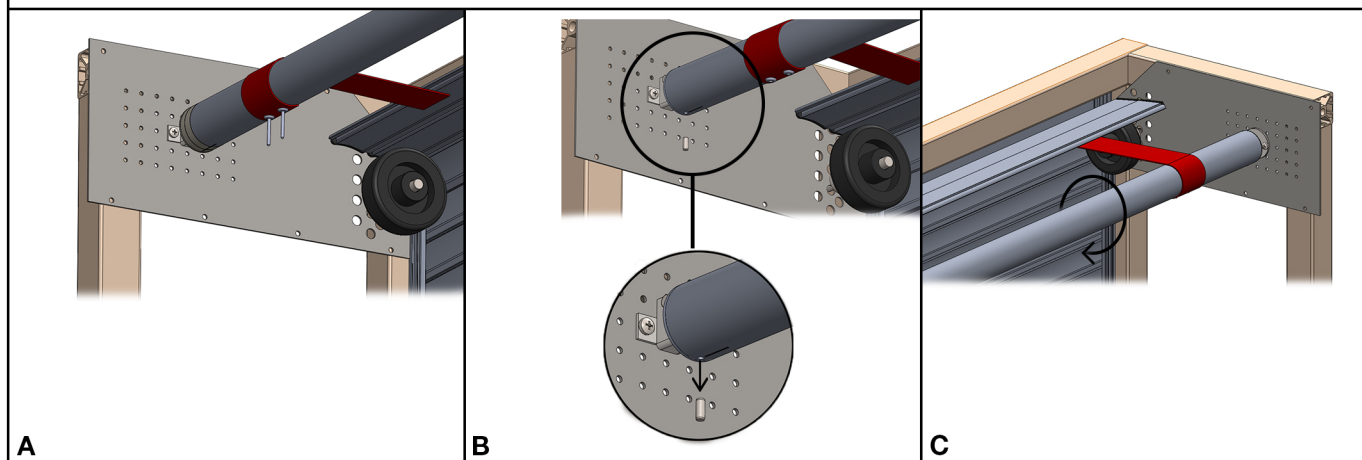

17. Fix the shutter control panel.

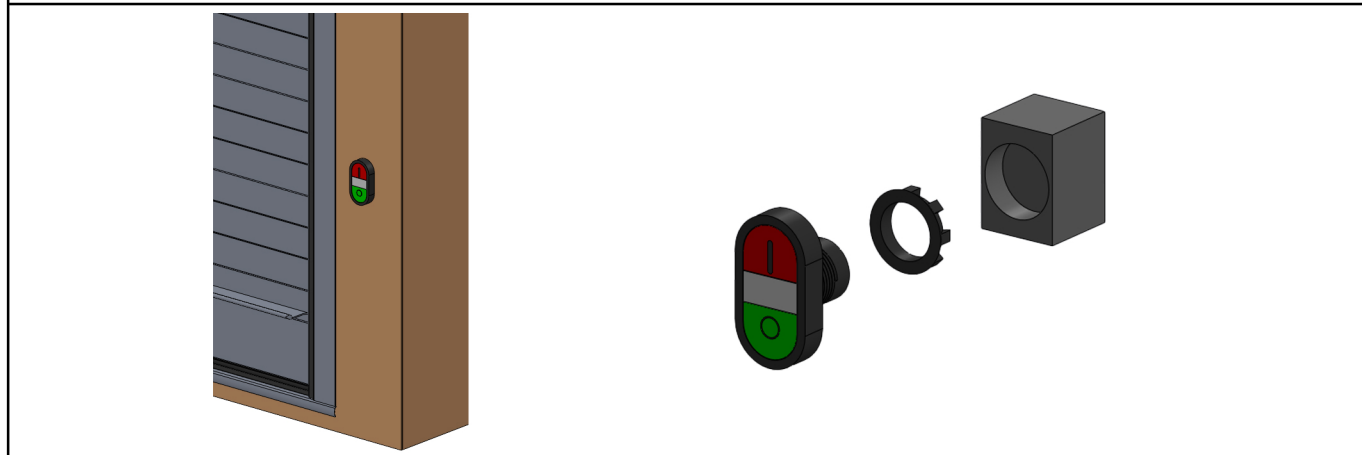

18. On the closing system's back cover, drill and fix the support for the limit switch on the motor side, with its screws.

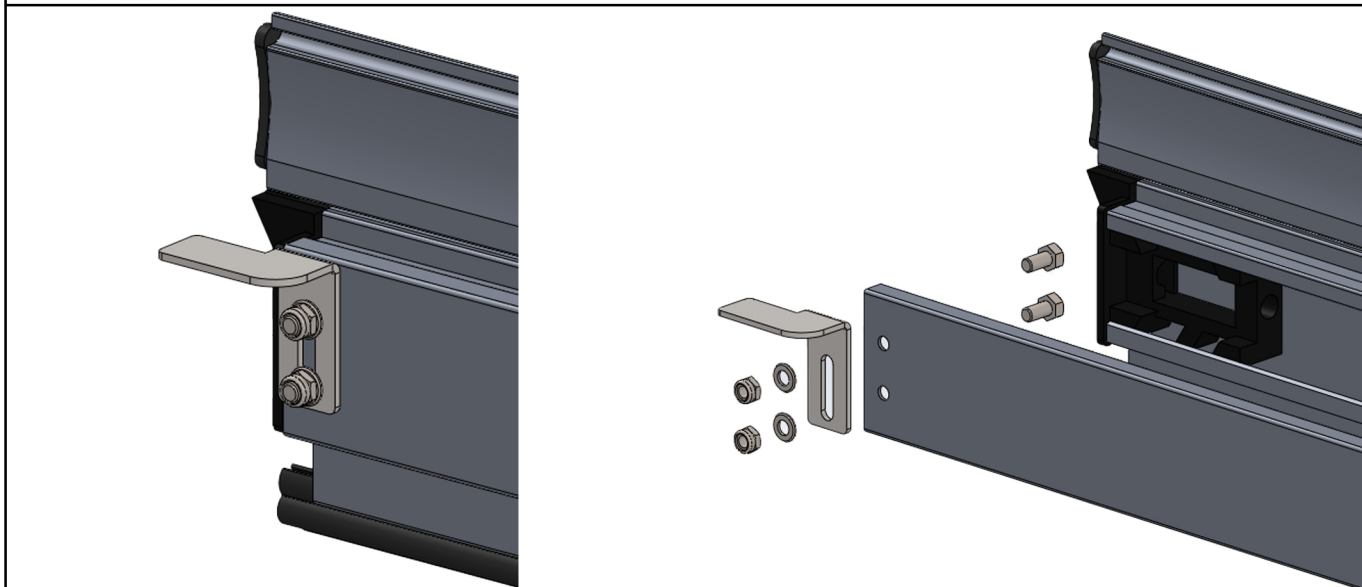

19. Screw the limit switches the their supports, fixed before on the guide, by the supplied screws. TE ø4 X 20

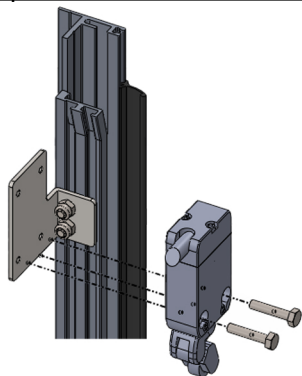

UPPER
LIMIT SWITCH

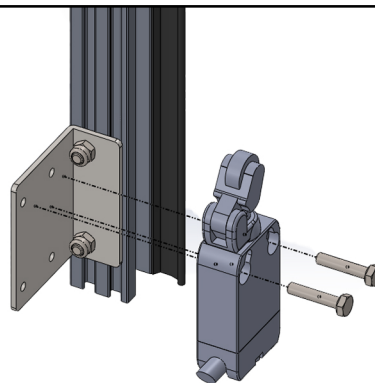

LOWER
LIMIT SWITCH

20. Drill and fix the lower profile (optional). Insert the rubber, if you chose the big gutter profile.

BIG GUTTER PROFILE

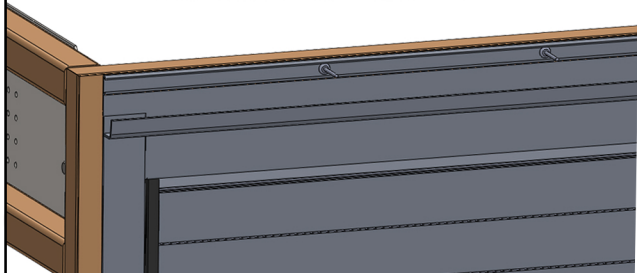

SMALL LOWER PROFILE

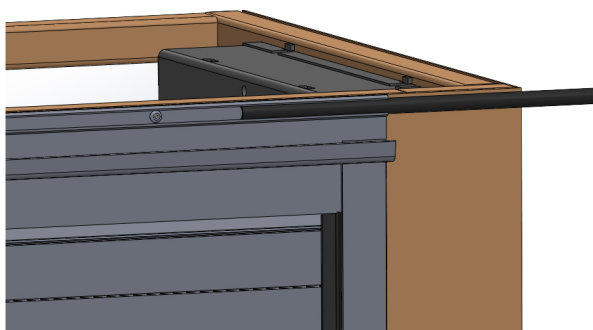
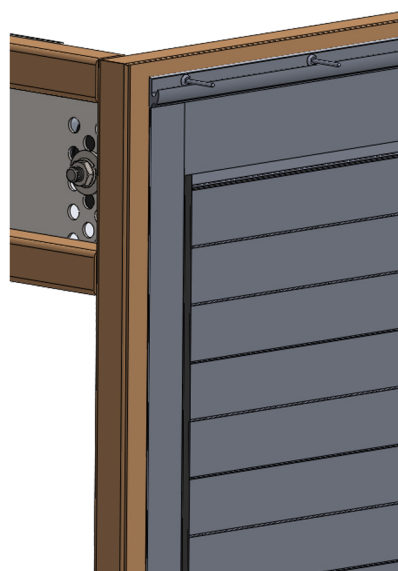

BIG GUTTER PROFILE



SMALL LOWER PROFILE



21. The shutter is ready to be used. For a better sliding over time, it is recommended to grease the side guides with standard mechanical grease.



Make the electrical connections to operate the motor and move electrically the shutter via push-button panel and limit switch.

Wiring of the parts supplied at the expense of the customer.